

DESCRIPTION

The Camlok RH and WH horizontal series of plate clamps can be used with all types of materials in plate form providing that the plate can withstand the forces imposed upon it. The Roller Toe is designed to reduce any surface damage to the plate. The clamps are used in pairs for short plate lengths, for longer plates 2 pairs of clamps and a beam must be used.

DIAGRAM

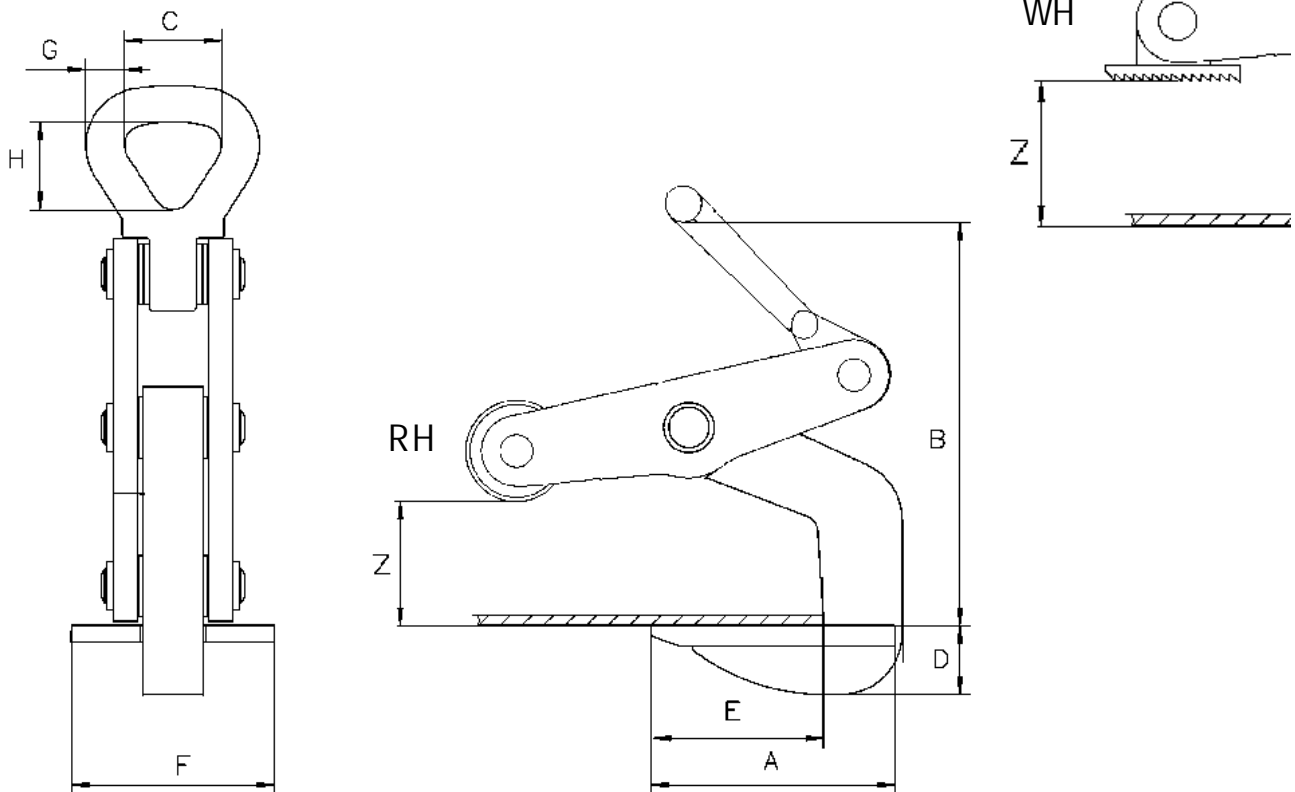

TABLE

MODEL	WLL Tons	Plate mm Z	Weight kg	A	B	C	D	E	F	G	H
WH/RH 30	1,5	5 - 60	13	120	200	50	22	65	100	36	73
WH/RH 50	2,5	10 - 70	25	150	275	64	38	77	100	58	92
WH/RH 70	3,5	10 - 80	36	185	292	64	48	105	100	65	92
WH/RH 100	5,0	10 - 102	72	210	345	89	45	120	120	80	130

RESTRICTIONS

Included angle between chain and sling is not to exceed 90 degrees.

FOR SHORT PLATES

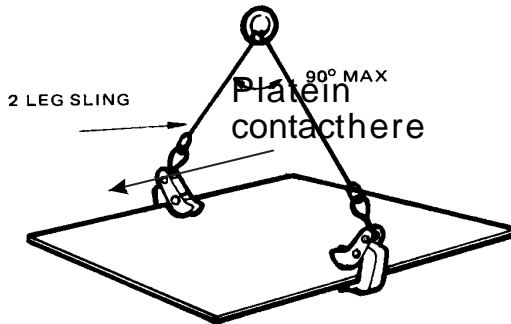

Use one pair of clamps for short plates

FOR LONG PLATES

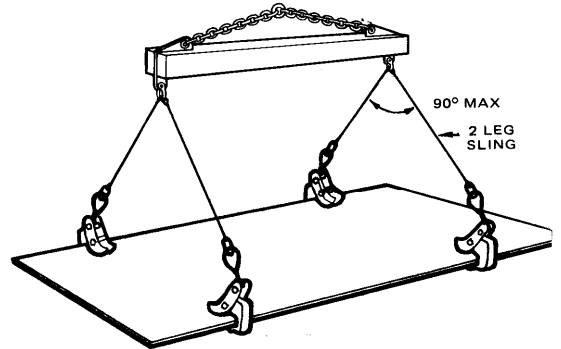

Use a lifting beam or a spreader beam for long plates. DO NOT use endless chain slings or 4 leg slings.

Check the plate is in contact with the back of the clamp. Bundles must be the same width and size.

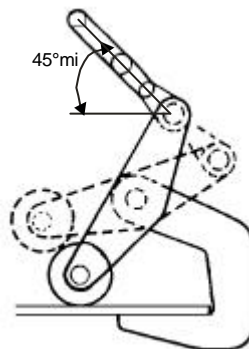

OPTIONS

The WH Clamp has a serrated toothed pivoting jaw as standard; this clamp can be fitted with Secutex reinforced plastic pads to protect the surface of the material if required

RH



WH



Soft-Jaw
WH

