

HoistQuip Ltd

T 01743 446666
F 01743 442448

S
H
A
C
K
L
E
S

QUALITY RANGE
LARGE DEE SHACKLES
TO BS 3032 - 1958 - TABLE 2
TYPE 'A' SCREW PIN - TESTED AND CERTIFIED

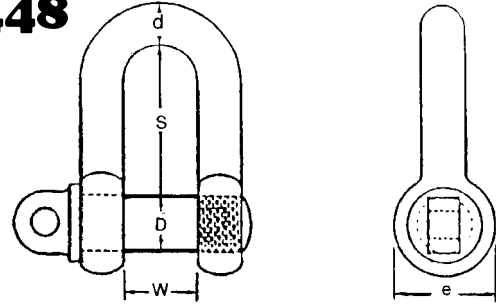

SWL TONS	d in	D in	W in	S in	e in	WEIGHT EACH KGS
0.25	1/4	3/8	1/2	1	3/4	0.06
0.50	3/8	1/2	3/4	1.1/2	1	0.16
0.75	1/2	5/8	1.1/8	2.1/8	1.1/4	0.35
1.50	5/8	3/4	1.1/4	2.1/2	1.1/2	0.63
2.00	3/4	7/8	1.1/2	2.7/8	1.3/4	1.00
3.00	7/8	1	1.3/4	3.1/4	2	1.54
3.75	1	1.1/8	2	3.3/4	2.1/4	2.21
5.00	1.1/8	1.1/4	2.1/8	4.1/8	2.1/2	3.11
6.00	1.1/4	1.3/8	2.3/8	4.1/2	2.3/4	4.33
7.00	1.3/8	1.1/2	2.5/8	5	3	5.33
9.50	1.1/2	1.3/4	2.3/4	5.3/8	3.1/2	8.46
11.25	1.5/8	1.7/8	3	5.3/4	3.3/4	10.48
13.00	1.3/4	2	3.1/4	6.1/8	4	12.66
14.25	1.7/8	2.1/8	3.5/8	7	4.1/4	15.34
16.25	2	2.1/4	3.7/8	7.3/8	4.1/2	18.50
18.00	2.1/8	2.3/8	4.1/8	7.3/4	4.3/4	23.80
20.00	2.1/4	2.1/2	4.1/4	8.1/4	5	28.60

ECONOMY RANGE
LARGE DEE SHACKLES
GENERALLY TO BS 3032 - 1958 - TABLE 2
TYPE 'A' SCREW PIN - TESTED AND CERTIFIED

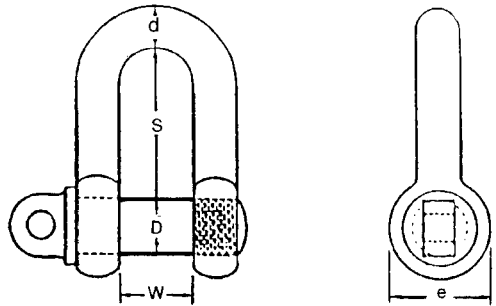

SWL TONS	d in	D in	W in	S in	e in	WEIGHT EACH KGS
0.50	3/8	1/2	3/4	1.1/2	1	0.16
0.75	1/2	5/8	1.1/8	2.1/8	1.1/4	0.35
1.50	5/8	3/4	1.1/4	2.1/2	1.1/2	0.63
2.00	3/4	7/8	1.1/2	2.7/8	1.3/4	1.00
3.00	7/8	1	1.3/4	3.1/4	2	1.54
3.75	1	1.1/8	2	3.3/4	2.1/4	2.21
5.00	1.1/8	1.1/4	2.1/8	4.1/8	2.1/2	3.11
6.00	1.1/4	1.3/8	2.3/8	4.1/2	2.3/4	4.33
7.00	1.3/8	1.1/2	2.5/8	5	3	5.33
9.50	1.1/2	1.3/4	2.3/4	5.3/8	3.1/2	8.46

IMPORTANT NOTICE

Please specify **Economy Range** each time you require them as it is our policy to supply our Quality Range as standard.